

PX UNDERWATER

Specific adhesive for bonding and grouting individual pieces of glass mosaic under water.

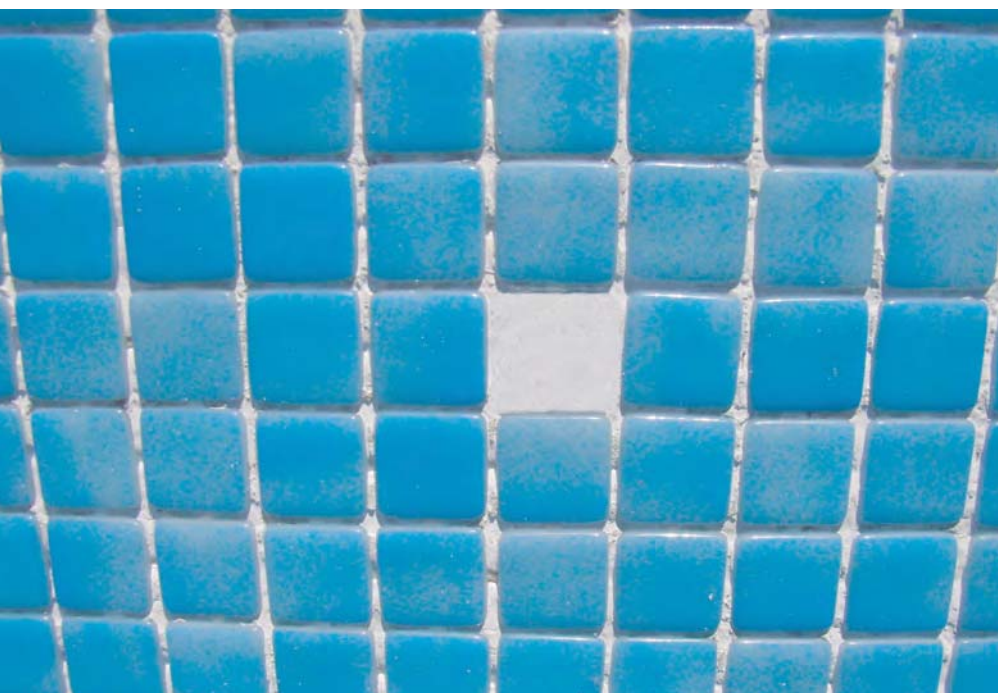

ATTENTION

PX UNDERWATER must not be used:

- ◆ In other applications without previously consulting the Technical Department.
- ◆ Overlapping under water.
- ◆ On other surfaces than concrete or mortar.



Bi-component product

FIELDS OF APPLICATION

- Product for bonding vitreous mosaic pieces or porcelain stoneware pieces inside swimming pools filled or not with water.
- Allows **gluing** of individual pieces, that is, they must be surrounded by other pieces that will act as an anchor for the new piece glued with **PX UNDERWATER**.
- 2 in 1 product: with the excess material that protrudes through the joints, we will perform the **grouting**.

TECHNICAL CHARACTERISTICS

PX UNDERWATER is a specific adhesive that polymerizes with or without the continuous presence of water.

Its characteristics distinguish it for its:

- ◆ Very high mechanical resistance in flexion and compression.
- ◆ High wear resistance.
- ◆ High adherence in the most difficult situations.
- ◆ High resistance to UV rays.
- ◆ Very good chemical resistance.

HOW TO USE

◆ Preparation of the support:

The correct, exhaustive and detailed cleaning of the **gap** between pieces is the only guarantee to ensure a very durable grip. Underwater application is by definition very complicated as the applicator will need to dive repeatedly to properly clean the gap between parts.

The premise of this previous preparation will be to ensure that there are NO remains of the old adhesive that held the fallen piece, that is, we must clean up until we reach the waterproofing that was below the adhesive cement. (see drawing n°2 of the steps to follow)

◆ Preparation of the adhesive:

PX UNDERWATER is a bi-component product: it is **mandatory** to mix intensively with a mixer attached to an electric drill for 2-3 minutes.



◆ Application of the adhesive:

- a.- first of all, the applicator must put on disposable nitrile gloves.
- b.- then you must apply a good amount of **PX UNDERWATER** on the back of the piece to be placed. The objective is that the surplus product protrudes through the joints and acts as a grout.
- c.- then they must be submerged in the pool with the mosaic piece and the **PX UNDERWATER** adhesive on the back of the piece.
- d.- place the piece in the corresponding hole and press with great force so that the adhesive expels all the water from the hole and with this we will get the adhesive to come into contact with the pool's mortar base.
- e.- with the excess adhesive that protrudes through the joints, we will fill the joints between pieces.

In summary: follow the following illustrations:

CONSUMPTION

PX UNDERWATER	10-20 grams/piece 25x25mm
---------------	---------------------------

TECHNICAL DATA

PX UNDERWATER

PRODUCT:

- Type: reaction adhesive
- Aspect part "A": dense paste
- Aspect part "B": viscous liquid
- Toxicity: contact with skin and eyes should be avoided. Always wear gloves during donning, and protective glasses are recommended. In case of skin contact, wash with plenty of soap and water. In case of contact with the eyes, wash with plenty of running water and consult a doctor.

APPLICATION:

- Application temperature: +20°C to +35°C
- Useful life: 1 hour (at +20°C)
- Drying under water at: 72-96 hours (at +20°C)
- Total hardening under water at: 7 days (at +20°C)

STORAGE:

- In covered, dry and ventilated places: 3 years

PRESENTATION:

- Supplied in: in 0.2 kgs. cans

1



- Two-component mortar. Mix mechanically with an electric stirrer.

2

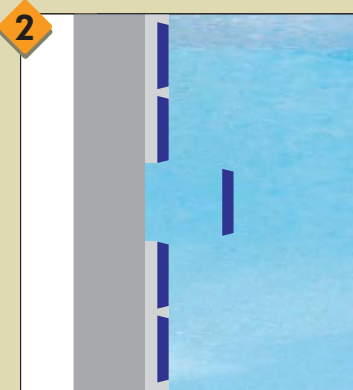

- Completely empty the hole where the new piece will go.

3

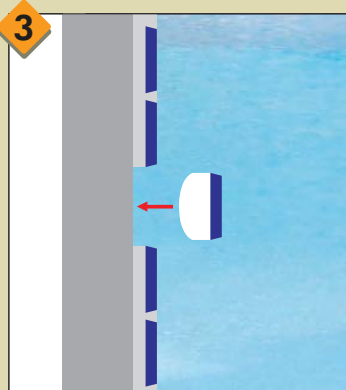

- Apply a large amount of **PX UNDERWATER** to the back of the piece to be glued.

4

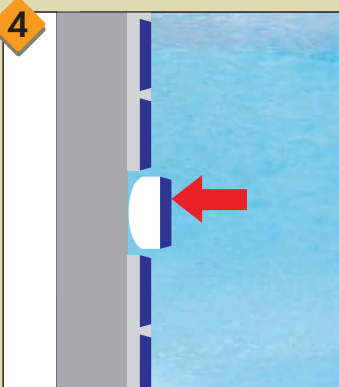

- Put the piece in place and press with a lot of force

5

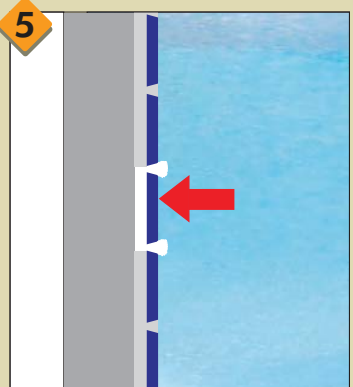

- until the product protrudes through the joints between pieces.

6

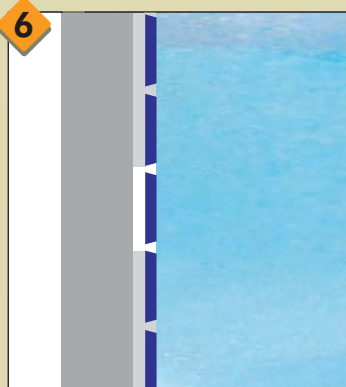

- Immediately clean the remains of **PX UNDERWATER**.